



RESILIENT WALL TIES-08 RANGE

Airborne and impact noise reduction

Matrix-08 Range of Masonry and Stud Resilient Wall Ties



MB08-Range



SB08-Range

The Matrix 08 range of resilient wall ties are a structural connection that reduces airborne and impact noise passing through masonry and stud walls. They are particularly suitable for the discontinuous construction of masonry and stud separating walls for apartments, villas & duplexes and any specialised room that requires high acoustic isolation such as cinemas, auditoriums and recording studios.

The Matrix 08 Range of resilient masonry and stud wall ties is the first resilient wall tie made to order for the construction of new and/or existing masonry and stud walls. The ties can be ordered for cavities from 20mm to 100mm and with studs from 64mm to 92mm. The Matrix 08 range offers the builder, architect or specifier the ultimate in the selection of suitable resilient ties for discontinuous construction. They are available in galvanised or stainless steel, or with the tail in aluminium for fire rating of stud walls.

Wall Construction	Cavity (mm)	Stud width (mm)	Galvanised	Stainless Steel	Aluminium
Existing masonry or Stud to Stud	20-50	64	SB08GA50	SB08SS50	SB08AL50
Existing masonry or Stud to Stud	50-75	75 & 92	SB08GA75	SB08SS75	SB08AL75
Existing masonry or Stud to Stud	75-100	75 & 92	SB08GA100	SB08SS100	SB08AL100
Existing Masonry to New Masonry	20-50	N/A	MB08GA50	MB08SS50	N/A
Existing Masonry to New Masonry	50-75	N/A	MB08GA75	MB08SS75	N/A
Existing Masonry to New Masonry	75-100	N/A	MB08GA100	MB08SS100	N/A

www.matrixindustries.com.au

144 Oxley Island Road, Oxley Island, NSW 2430 Australia

Email: info@matrixindustries.com.au



RESILIENT MASONRY WALL TIES

Airborne and impact noise reduction

	Separating Walls	External Walls
Material:	1.5 Galvanised Steel	1.5mm Stainless Steel
Durability:	R1	R4
Environment	Internal use only eg non weather walls	All exposure categories including coastal and Industrial

	MB08	SB08
Type	"A"	"A"
Category of Wall Tie	Cavity	Cavity
Classification of Tie	MEDIUM DUTY	MEDIUM DUTY
Minimum Cavity Width	20mm	20mm
Maximum Cavity Width	100mm	100mm

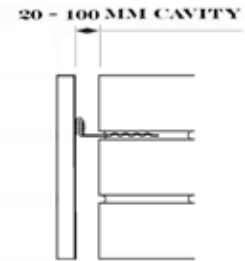

SPACING OF TIES:

In general work not more than 600 x 600 for a design wind speed (non cyclonic) of W28-W41. Reference should be made to the BCA vol2, part3-3-3 Masonry Accessories.

DISCONTINUOUS CONSTRUCTION:

Where a wall in a building is required to have an impact sound insulation rating under the requirements of the Building Code of Australia (BCA), such as between a bathroom, sanitary compartment, laundry or kitchen and a habitable room (other than a kitchen) in an adjoining building or unit, then for an acceptable masonry wall system, the ties should be Matrix Industries MB08 or SB08 resilient wall ties and the wall will be deemed to comply. Two leaves of standard 110mm clay brick masonry, min 50mm cavity, Matrix Industries MB08 resilient wall ties and either 50mm cavity insulation or 13mm cement render to each outside face will achieve $R_w + C_{tr}$ not less than 50 and discontinuous construction.

FASTENING REQUIREMENTS:

Matrix recommends 6x30mm Ramset ShureDrivetm anchors which have a maximum load of 1.0 kN, or No. 12 Type 17 screw or equivalent.



MB01



MB04



SB03



FM01



SB06

www.matrixindustries.com.au

144 Oxley Island Road, Oxley Island, NSW 2430 Australia

Phone: +61 2 6553 2577 - Fax: +61 2 6553 2585

Email: info@matrixindustries.com.au