



# RESILIENT MASONRY WALL TIE

## MB10 - Wide Cavity Acoustic wall tie

**Masonry and Stud Cavity Construction for  
Airborne and impact noise reduction**



### **MB10 - design allows for variable cavity widths while maintaining strength and vibration isolation**

The MB10 resilient wall tie is designed for a wide cavity as a structural connection that reduces airborne and impact noise passing through masonry walls. They are particularly suitable for the discontinuous construction of masonry or stud separating walls for apartments, villas & duplexes and any specialised room that requires high acoustic isolation such as cinemas, auditoriums and recording studios.

The MB10 is suitable for connecting existing masonry or stud walls to brick or hebal walls. When a fastener is inserted through the holes and the wall tie fixed to a masonry or stud wall, the two halves of the tie remain isolated by the uncompressed foam. This is the basis of a resilient wall tie that can transmit structural loads but acoustically isolates noise and vibration from passing through the wall.

**[www.matrixindustries.com.au](http://www.matrixindustries.com.au)**

**144 Oxley Island Road, Oxley Island, NSW 2430 Australia**

**Phone: +61 2 6553 2577 Fax: +61 2 6553 2585 Email: [info@matrixindustries.com.au](mailto:info@matrixindustries.com.au)**



# RESILIENT MASONRY WALL TIE

## MB10 - Wide Cavity Acoustic wall tie

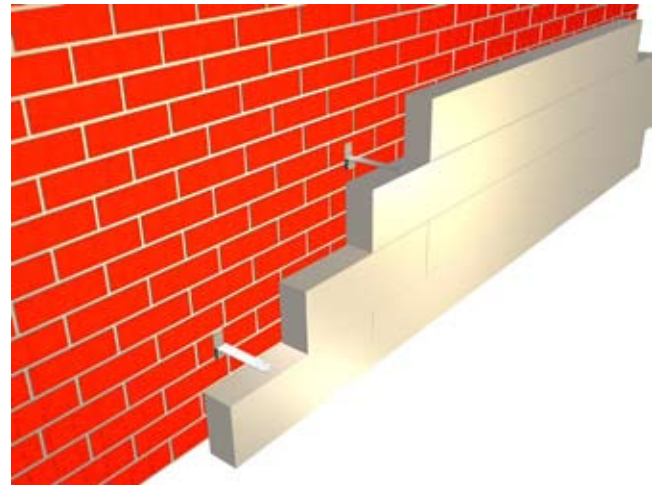

MB10 ties can be attached to masonry using shuredrive™

Type: "A"  
Category Of Wall Tie: Cavity  
Classification Of Tie: HEAVY DUTY  
Rated Cavity Width: Variable  
Maximum Cavity Width: Variable

	<b>Separating Walls</b>	<b>Internal Walls</b>
--	-------------------------	-----------------------

**SPACING OF TIES:** In general work not more than 600 x 600 mm.

**STRUCTURAL PERFORMANCE-**Matrix Industries MB10 wall ties are capable of transferring structural lateral forces (e.g. wind loads) from one masonry leaf to the other. They are classified as a heavy duty cavity tie with a minimum characteristics strength of 1kN in tension and 1 kN in compression.

**NOISE REDUCTION:**MB10 resilient wall ties were assessed in field tests comparing identical isolated and non-isolated rooms within the same building.

**DISCONTINUOUS CONSTRUCTION:** Where a wall in a building is required to have an impact sound insulation rating under the requirements of the Building Code of Australia (BCA), such as between a bathroom, sanitary compartment, laundry or kitchen and a habitable room (other than a kitchen) in an adjoining building or unit, then for an acceptable masonry wall system, the ties are to be Matrix Industries MB10 resilient wall ties and the wall will be deemed comply.

[www.matrixindustries.com.au](http://www.matrixindustries.com.au)

144 Oxley Island Road, Oxley Island, NSW 2430 Australia

Phone: +61 2 6553 2577 Fax: +61 2 6553 2585 Email: [info@matrixindustries.com.au](mailto:info@matrixindustries.com.au)